

MOBIDERM

SLEEVES

Anatomical Markers

- Ⓒ corresponds to the axilla (armpit)
- Ⓓ corresponds to the widest point of the biceps
- Ⓔ is located at the level of the olecranon
- Ⓕ equidistant between A and C or at the starting site of the edema
- Ⓖ to be measured at the narrowest point of the wrist external face in the middle of the radial ulnar joint

The arm must be slightly bended when taking measures.

➔ *Positioning of the measuring tape to measure heights.*

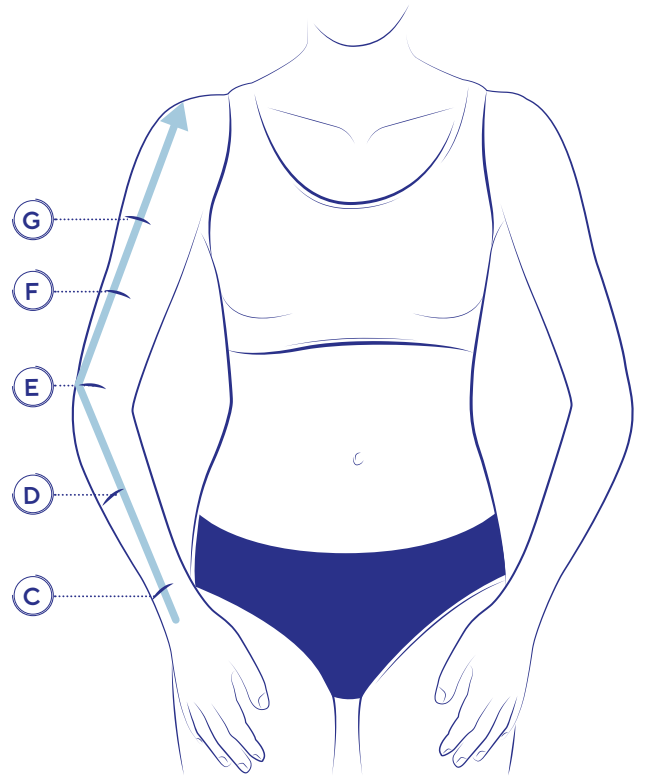

Measurement Instructions

ARMSLEEVE

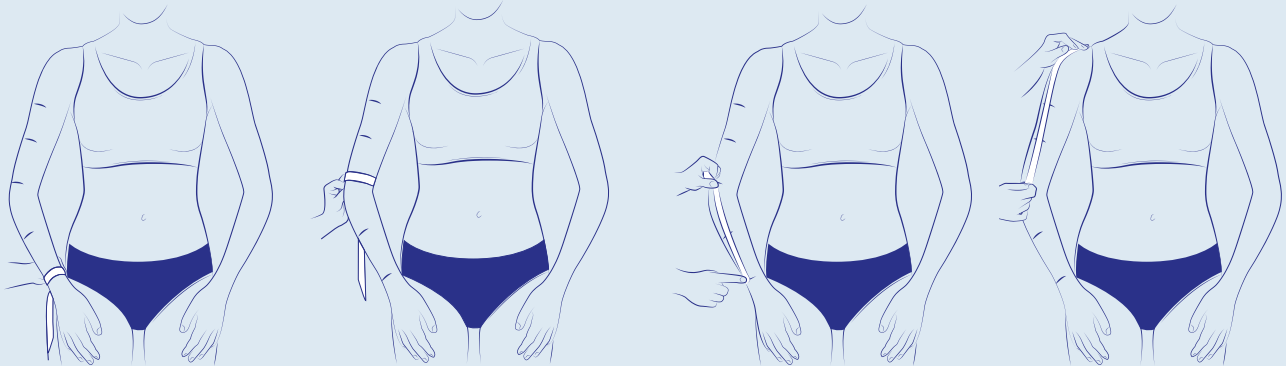

The lengths must be measured from the middle of the wrist to the tip of the elbow, then on the outside of the arm up to the desired finished height.

MITTEN

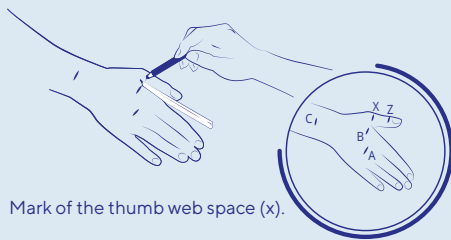

Mark of the thumb web space (x).

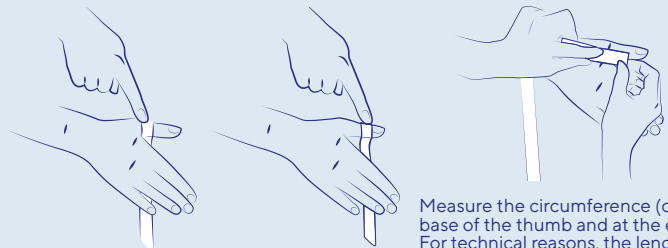

Measure the circumference (cX) at the base of the thumb and at the end (cZ). For technical reasons, the length of the thumb (XZ) cannot be less than 2 cm.



The circumference at the end of the mitten (cA) is located at the head of the metacarpal bones.



Measure the length of the mitten:
1/ from the wrist (C) to the base of the thumb (X)
2/ from from the wrist (C) to the finished height (A)